



Swingarm Bearing



Swingarm Bearing Assembly Kit contains parts pictured for 1952-81.

VT No.	Fits
44-0539	1952-73
44-0538	1974-81

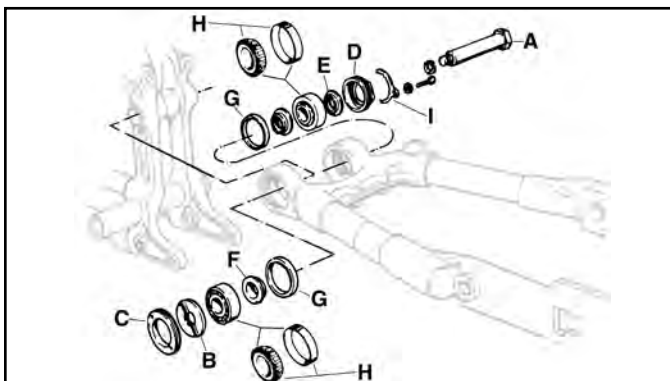

Pivot Pin Hardware for 1952-81 models.

VT No.	#	Year	Item
44-0107	A	1952-81	Pivot Bolt, chrome
44-0098	B	1952-73	Nut
44-0097	B	1974-81	Nut
44-0096	C	1952-73	Locknut
44-0095	C	1974-81	Locknut
44-0088	D	1954-73	Locknut, Right
44-0087	D	1974-81	Locknut, Right
44-0094	E	1952-73	Outer Spacer
44-0093	E	1974-81	Inner Spacer
44-0367	F	1952-81	Spacer, pair
44-0110	G	1952-81	Shield, pair
44-0108	H	1952-73	Bearing Set
44-0109	H	1974-81	Bearing Set
17-0920	I	1952-81	Locktab



Smooth Swingarm Pivot Covers Set covers end of pin.

VT No.	Year
37-1206	2004-up
37-9522	2004-up

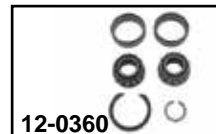
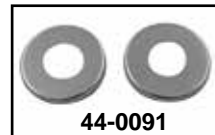
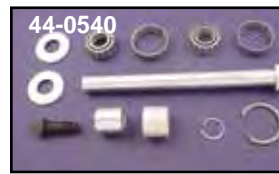

Pivot Bolt Kit includes black pin, screw, spacer, bushing, bearing and dust covers.

VT No.	Item
44-0540	1982-03 Kit
44-0709	2004-up Kit
44-0714	2004-up Kit, Chrome
44-0875	2004-up Kit
44-0872	2004-up, Pivot Shaft, Zinc
44-0092	1982-03 Bolt/Nut
44-0151	2004-up Bolt/Nut
44-0091	1982-up Dust Cover (2)
12-0362	1982-03 Bushing, Left
12-0360	1981-99 Bearing, Right
12-0127	2004-up Bearing, Right
44-0626	2004-up Pivot Retaining Ring



Swingarm Pivot Kit. Includes all parts shown for 1952-80 XLH-XLCH Sportster models.

VT No.	Fits
44-1959	1952-73
44-1960	1974-80



XL-XLH Model Swingarm Bearings and Kits.

VT No.	Years	Item	U/M
44-0108	1952-73	Four Piece	Kit
12-0332	1952-73	Bearing	Pair
12-1100	1952-73	Race Set	Pair
44-0109	1974-81	4 Piece	Set
12-0333	1974-81	Bearing Set	Pair
12-1101	1974-81	Race Set	Pair