

News Flash!

After 93 years, Harley-Davidson has discontinued the sidecar as of August 2010 as told by Sarah Harley, granddaughter of William Harley, cofounder of Harley-Davidson.

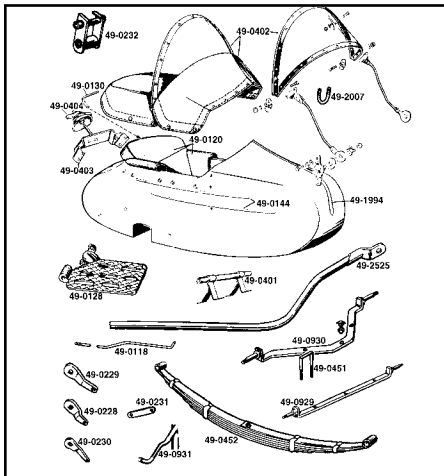

1936-65 Sidecar Body and Accessories

VT No.	OEM	Item
49-0118	87732-41	Brake Rod
49-0788	87750-58	Side Car Wheel Cylinder with inverted flare fits 1958-79 Side Car Brake
2663-7	Parkerized	1936-40 Step U Mount Bolts
2661-7	Parkerized	1947-64 Step U Mount Bolts
2616-4		Step Bolts, 1941-64
2617-3		Step Bolts, 1936-40

Sidecar Wrenches are heavy duty for shop use. 1 1/4".
VT No. 16-0111

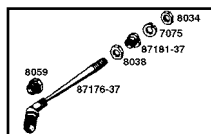

Sidecar Mounting Fittings are precision machined fittings that are replicas of the original.

VT No.	OEM	Application
49-1945	87176-37	Front Tie Rod
49-0999	87254-24	Nut and Ball Stud Set
49-1977	87254-24	Ball Stud
49-1979	87135-36	Upper conn. bolt
49-1980	87265-24	Joint Lock Nut
49-1981	87197-36	Rear frame mount 1936-57
49-0134	87267-24	Joint Lock Nut
49-1947	87181-37	Tie Rod Spacer
49-1949	8034	Tie Rod Outer Nut
49-1950	8038	Rod End Nut
49-1948	8059	Tie Rod Nut
49-1996	—	Threaded Ball Socket

Lower Front Mount Tie Bar Assembly. Parkerized reproduction of fasteners used 1924-84 Sidecars.
VT No. 2692-5

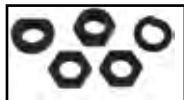

Lower Front Mount Tie Rod Ball Joint. Exact reproduction of ball joint used on 1924-84 Sidecars. Replaces OEM 87254-34.
VT No. 2690-1



Sidecar Support Rod Bushing and Stud Kit.
VT No. 2433-18



Sidecar



Replica Sidecar Fender Lamp fits 1934-65 models.
VT No. 33-0406



Fender Lamp. OEM# 59260-68.
VT No. 33-0402

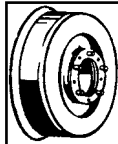

Sidecar Brake Drum and Shoes.

VT No.	OEM	Item	Year
23-1993	44402-36	Shoes	1936-57
23-1770	44113-36	Drum	1936-48
23-0501	41801-58A	Shoes	1958-79
49-0788	87750-58	Wheel Cylinder	1958-79

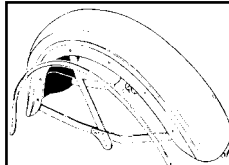

50-0524



51-0295



49-0405

Sidecar Fender assembled with brackets for 1936-65 Early 67 Sidecars. Stainless trim with clips,

VT No.	Item
50-0773	1936-Early 67
50-0524	1967-09
49-0405	1936-Early 67 Trim
51-0295	Windshield
31-1642	Bracket

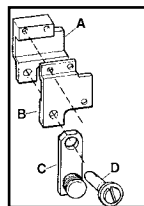

Rear Clamp Connector

VT No.	#	OEM
49-1986	A	87083-87
	B	87084-73
49-0135	D	87192-73



Sidecar Axle Hardware for 1936-65.

VT No.	OEM	Item
2614-7		Axle Mount Kit
2622-5		Longer Axle Extension
2621-5		Axle Extension



2766-4

Sidecar Spring Bushing Kit.

Reproduction of 88174-37 bushings used on 1937-84 Sidecars.
VT No. 2766-4



Lower Front Mount Tie Rod Ball Joint Nut and Lock Nut Kit.

Reproduction of OEM 87265-24 nut and 87267-24 locknut. Used on 1924-84 Sidecars.
VT No. 2691-2



2617-3

Sidecar Step to Fender Mounting Kit. Parkerized reproduction of original fasteners.

VT No.	Year
2617-3	1936-40
2616-4	1941-64

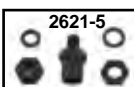

2621-5

Axle Extension Nut Kit. Exact reproduction of fasteners used on 1930-early 1967 Sidecars.

VT No.	Year
2621-5	Standard length 87438-30 nut
2622-5	Extra long 87438-30 nut

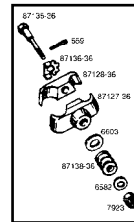

Upper Connection Parts are available separately for 1936-up sidecar.

VT No.	OEM	Item
49-1995	87127-36	Clamp
	87128-36	
49-1979	87135-36	Bolt
49-2531	87136-36	Lock tab, 5 pack
49-1156		Kit



Sidecar Connector Kit comes complete with upper, front and lower for the years listed for 74" and 80" Big Twins.

VT No.	OEM	Fits
49-1990	87082-36	1937-57 Rigid
49-1991	87082-58	1958-72 SA
49-1992	87082-73	1973-79 S



Clamp Bracket Set includes 87205-58, 87206-58 with four U-Bolts.

VT No.	Item
49-1989	Bracket Set
21-0315	U-Bolt, each
2705-5	Parkerized, each



87197-36

Rear Connector.

VT No.	OEM	Item	Type
49-1981	87197-36	Mount only	1936-57 Rigid
49-1983	87197-58	Mount only	1958-72 SA
49-0154	87192-58	Stud only	1958-72
49-0135	87192-73	Stud only	1973-80

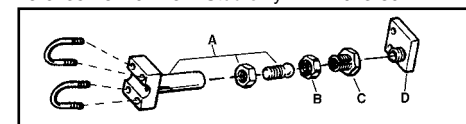

Clamp On Rear Mount for mounting side cars on 1979-84 Classic & FLH models.

VT No.	#	OEM	Item
49-1988	A	87106-79	Connection Fitting
49-0134	B	87267-24	Joint Lock Nut
49-1980	C	87265-24	Joint Nut

Sidecar Frame Brace Upper Connection Kit. Parkerized accurately duplicated fasteners used on 1937-1979 sidecars.
VT No. 2620-7

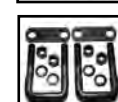

Spring to Frame Mounting Kit. Correct parkerized reproductions of 88172-25 U-bolts, 88170-24 shims, washers and nuts used on 1925-84 Sidecars.
VT No. 2716-8



23-1949 Installed

Emergency Brake Kit

VT No.	Year	Type
23-1949	1936-73	Foot
49-0934	1941-74	Front
26-0948	1951-64	Front