



# K and XL Parts



**1952-78  
Replica Style  
3.5 Gallon  
Tank for XL's.  
VT No.  
38-0038**



**Replica Leather WR Model Solo Seat** is covered with genuine leather on a stock formed steel ribbed baseplate, constructed as original with rolled sewn edge with riveted under strip, replaces 52000-40. Available in black which bolts to any stock seat tee as custom or stock replacement.

**VT No. 47-0110**



**Leather XLCH  
Seat** measures  
13.5" x 13.5" fits  
31-0512 seat tee.  
**VT No. Color**  
**47-0158 Black**  
**47-0164 Brown**



**1952-70 XL Large Cap** replaces  
61103-52.  
**VT No. 38-0329**



**1952-54 K-Petcock** replaces 62125-50, die cast with threaded end for line.  
**VT No. 35-0650**

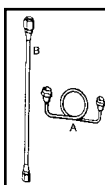

**K-Model 1952-54 Steel Gas Lines.**  
**VT No. # OEM Line Finish**  
**40-1261 A 62355-52 Cross Cad**  
**40-1264 A As Above Cross Chrome**  
**40-1260 B 62357-52 Gas Cadmium**



**33-2120**



**33-2120A**



**33-2254**



**33-0072**

**7" K Headlight** features oil/generator lamps and sockets, replaces 67704-52. Unit includes chrome rim and 6 volt sealed beam.

**VT No. Finish**  
**33-2120 Chrome, Complete**  
**33-2120A Shell**  
**33-2254 Black, Shell**  
**33-0072 Black 7" Headlamp with rim**



**Replica Steel Rear Fender** features full length style with rear flare, without taillight cut. Mount for 1955-72 type must be cut in.  
**VT No. 50-1068**

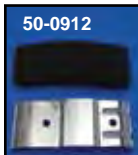

**50-0912 Chrome Rear Fender Bracket** fits 1954-78, reduces vibration between fender and frame, includes foam pad, replaces 59795-52A.  
**VT No. Item**  
**50-0912 Bracket with pad**  
**28-2246 Foam pad only**



**33-2151**

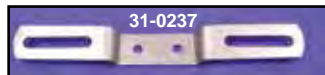

**31-0237**

**1952-54 Early Tail Lamp and Parts.** Note: Lenses are made of glass.

**VT No. OEM Item**  
**33-2151 K Tail Lamp Complete Kit with chrome hood**  
**31-0237 59991-52 K Model license plate bracket**

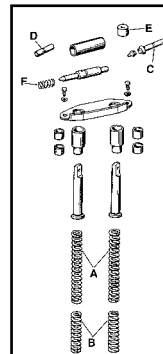

**31-4024**



**31-4083**

**Seat Plunger Kit** includes all parts pictured for 1954-70 KH-XL-XLCH-XLH Sportster models, to spring mount solo seat on stock frames. Some frames may require honing to fit bushing housing.

**VT No. Item**  
**31-4024 Complete Kit, All**  
**13-1952 4 Springs, Set (A and B)**  
**13-9173 Swivel Springs, Pin, (F)**  
**37-9114 Tee Bolt, (C)**  
**10-2564 Bushing, (D)**  
**10-2563 Spacer, (E)**  
**31-4083 Kit with Tee**

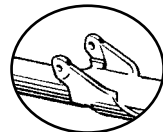

**Seat Mount Tabs** fit 1952-79 XL may be welded on for custom application, pair.  
**VT No. 51-0539**



**Coil Mount Studs** replace 64611-55, 64612-55 models, pairs. Fits 1955-67 XLH.  
**VT No. 37-9156**



**Chrome Shock Spring Covers** is replica type for shocks which disassemble at lower eye. Fit 1957-70 XL, 10 3/4".  
**VT No. 54-0402**



**K-Model Parts Books.**  
**VT No. 48-0525**

# Rim and Spoke



**52-0946**

**18" Chrome Replica™ Early Steel Wheel Rim** features conventional bead construction. Spoke nipple holes may require enlarging before assembly. Fits K Models.  
**VT No. OEM Fits**  
**52-0946\* 43003-30 Front**  
**\*Note:** Features reverse roll and deep dish spoke area to fit models with integral 1/2 brake drum.

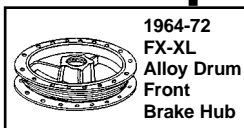

**1964-72  
FX-XL  
Alloy Drum  
Front  
Brake Hub**

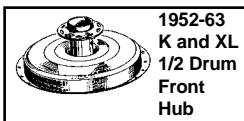

**1952-63  
K and XL  
1/2 Drum  
Front  
Hub**

Above Hubs are shown for reference only

**Spoke Sets** available for conventional or drop center rim type.

Chrome V-Twin	Chrome Buchanan	Stainless Buchanan	Rim Size	Rim Type*
<b>1964-72 XL-FX Front Drum</b>				
		45-0658	19"	Conventional
45-0622	45-0724	45-0657	19"	Drop Center
		45-0659	21"	Drop Center
<b>1952-63 XL-K Front</b>				
		45-0708	18"	Conventional
		45-0707	19"	Conventional