

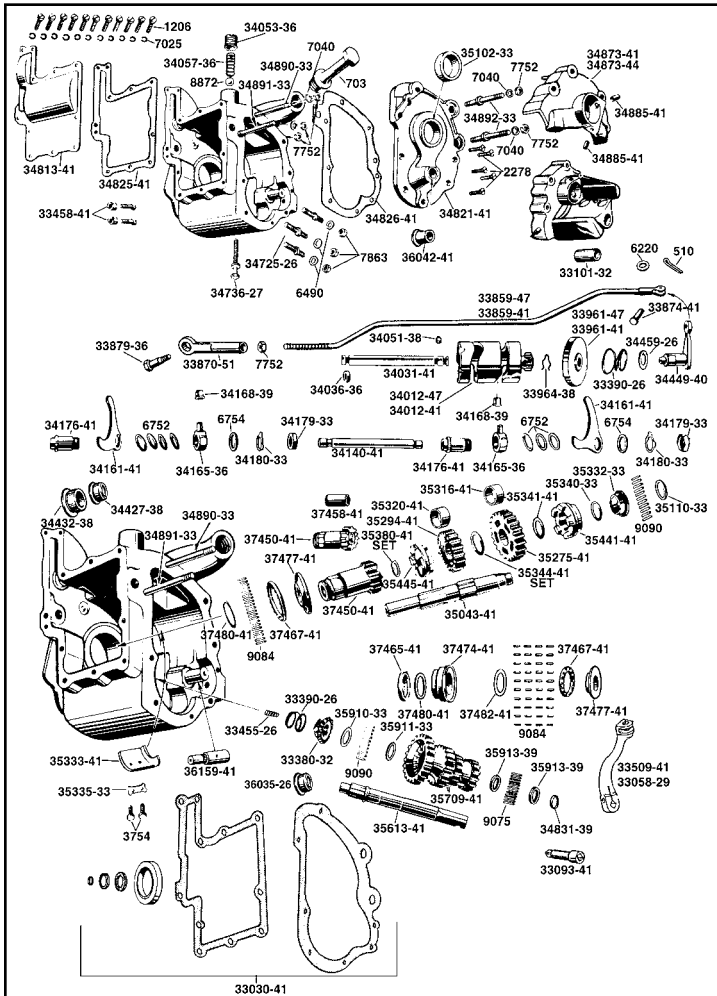

# 45" Transmission

45" Transmission Hardware for 1938-73 3-Speed and 3-Speed with reverse models.



VT No.	OEM	Item
8610-1	704	Fill Plug to 1940, Chrome
8611-1	704	Fill Plug to 1940, Cadmium
8631-1	703	Fill Plug, 1941-73 Chrome
2655-1	703	Fill Plug
9411-27	1206	Top and Side Cover Screw Kit, 1941-73 Cadmium
9410-27	1206	As Above, Chrome
9666-27	1206	As Above, Parkerized
2655-1	2326-35	Transmission Fill Plug
15-0607	33030-41	Gasket Kit
49-2581	33058-29	Kick Arm, Servi-Car, Black
13-9248	33084-41	Kick Spring, Black
13-0122	33084-41	Kick Spring, Chrome
9754-1	33088-41	Kick Stud, Chrome
9755-1	33088-41	Kick Stud, Cadmium
9756-1	33088-41	Kick Stud, Parkerized
49-1999	33093-41	Kick Shaft, Extension, Servi-Car
10-2493	33101-32	Bushing Starter Shaft
17-9867	33380-32	Starter Clutch
13-0167	33455-26	Countershaft Spring
37-8256	33456-26	Tripper Screw, 2 pack
9761-4	33456-26	Tripper Screw and Nuts
8628-6	33458-41	Nut, 6 pack
49-1931	33509-41	Arm, Black
37-9171	33874-41	Clevis Pin
49-1032	33961-47	Shift Gear
17-9772	34051-38	Lock Screw
17-0134	34031-41	Shifter Shaft Cam
49-0082	34140-41	Shift Fork Shaft
49-0203	34161-41	Shift Fork
17-0097	34165-36	Shifter Finger
17-0117	34168-39	Shifter Finger Rollers, pair
17-0049	34176-41	Shifter Finger Bushing
10-2518	34427-38	Shifter Shaft Small Bushing
10-2514	34432-38	Shifter Shaft Large Bushing
17-9832	34449-40	Inner Shift Lever
49-1671	34449-52	Inner Shift Shaft
17-0983		Shifter Lever Clip
14-0633	34459-26	Shift Leather Seal
49-0172	34702-41	45 Transmission Case
49-0269		Case
9837-10		Transmission Mount, Chrome
9838-10		Transmission Mount, Cadmium
8625-1	34736-27	Gear Box Adjusting Screw, Cadmium
9693-1	34736-27	As Above, Parkerized
9729-1	34736-27	As Above, Chrome
49-0080	34821-41	Side Cover
49-0205	34813-41	45" Trans Access Cover
14-0634	34831-39	Case Rubber Oil Seal, James
49-0419	34873-41	Sprocket Cover 1941-43 WL
49-0427	34873-44	Sprocket Cover 1944-53 WL
49-1722		Set
8621-16	34892-33	Chrome Sprocket Cover Stud Kit
8622-16	34892-33	Cadmium Sprocket Cover Stud Kit
9686-16	34892-33	Parkerized Sprocket Cover Stud Kit
N/A	2272-33	Main Shaft, 1933-40
49-0201	35043-41	Main Shaft, 1941-73
17-0821	35102-33	Replica Mainshaft 1941-73
17-9868	35102-33A	Main Shaft Outer Race
17-9884		As Above .005
17-9864	35110-33	Main Shaft Thrust Washer, 5 pack
12-0211	35195-26	Transmission Sprocket Key
19-0062	35204-41	17 tooth Countershaft Sprocket
17-0933	35216-26	Sprocket Lock Tab
14-0176	35221-36	Main Shaft Sprocket Seal
49-0414	35275-41	Main Shaft 1st Gear
17-9916	35284-41	Reverse Gear
17-9917	35294-41	2nd Gear
10-2515	35316-41	Low Gear Bushing
10-2517	35320-41	2nd Gear Bushing
10-2523	35326-33	Reverse Gear Bushing
17-9823	35332-33	45" Spacer Collar
2734-3		Lock Tab
17-9866	35340-33	Reverse Gear Thrust Washer, 5 pack
17-9865	35341-41	Low Gear Thrust Washer, 5 pack
17-9824	35344-41	Low and Second Gear Thrust Set
17-0149	33349-41	.040 to .075, 8 piece
17-9835	35380-41	Low and Second Gear .050 washer
49-0415	35441-41	Spacer Set
49-2004	35442-41	45" Low Gear, Shift Clutch
17-9834	35445-41	Shifter Clutch, Low and Reverse
49-0937	35612-64	45" Shifter Clutch, 2nd and 3rd
49-0202	35613-41	1964-73 45" Countershaft Elec Start
49-0204	35709-41	45" Trans Countershaft
49-0936	35709-64	45" Trans Cluster Gear 1941-63
17-9836	35709-64	1964-73 Electric Start
17-9837	35910-33	45" Outer Thrust, 5 pack
17-9838	35911-33	45" Inner Thrust
10-2547	35913-39	45" End Washer
10-2490	36035-26	Left Countershaft Bushing
17-9839	36042-41	45" Countershaft Bushing
8410-8	36141-41	Reverse Idler Gear
8411-8	37077-44	Clutch Arm Rebuild Kit 1944-52 Solo, Chrome
8904-6	37077-44	Clutch Arm Rebuild Kit 1944-52 Solo, Cadmium
8903-6	37076-41	Cadmium Clutch Arm Rebuild Kit 1941-43 Solo Chrome
8412-1	37287-41	As Above
14-0126	37335-41	45" Throw Out Bearing Assy 1941-73
49-0413	37450-41	45" Clutch Pushrod Seal 1941-up, 5 pack
10-0553	37458-41	45" Transmission Clutch Gear
12-0556	37460-41	Clutch Gear Bushing
9533-2	37460-41	Clutch Hub Nut
17-0925	37460-41	Clutch Hub Nut Kit
14-0169	37462-41	45" Clutch Hub Lock Tab
14-0642	37460-41	Clutch Gear Oil Seal
12-0343	37465-41	Clutch Gear Oil Seal, James
17-9926	47467-71	Thrust Bearing
17-9841	37474-41	45" Roller Bearing Race
17-9842	37477-41	45" Clutch Gear Bearing Race
17-9915	37480-41	Clutch Gear Thrustwasher, Left Side
	37482-41	Countershaft Washer

**45" Mainshaft Transmission Rollers set of 24.**  
**24 Pack** 100 Pack OEM Size  
 17-9211 12-4581 9075 Standard  
 17-9212 12-4582 9076 .0004  
 17-9213 12-4505 9077 .0008

**45" Countershaft And Mainshaft Rollers set of 40.**  
**40 Pack** 100 Pack OEM Size  
 17-9214 12-4584 9090 Standard  
 17-9215 12-4585 9091 .0004  
 17-9216 12-4586 9092 .0008

**45" Mainshaft Roller Set (44 Pieces Required)**  
**44 Pack** 100 Pack OEM Size  
 17-9217 12-4576 9084 Standard  
 17-9218 12-4577 9085 .00044  
 17-9219 12-4578 9086 .0006  
 12-4609 12-4579 .0008  
 17-9220 12-4580 .0010

**4-Speed 45" Transmission Kits for 1941-63 Kick Start**  
 VT No. Type  
 49-0871\* 3 Speed Complete  
 17-0731\* 4 Speed Complete  
 49-0851\* 3 Speed and Reverse Complete  
 49-0649\* 4 Speed Gear Kit 3-Speed  
 Converts 3-Speed to 4-Speed  
 49-0455 Door 4-Speed  
 \*Note: Clutch lever and housing not included.  
 \*\*Note: Requires VT No. 49-0455 door



WR 3rd Gear includes bushing and washer.

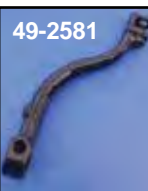
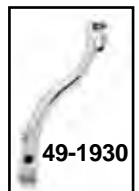

**45" Kicker Arms.**  
 VT No. OEM Type/Finish  
 49-1931 33509-41 Solo/Black  
 49-1930 33509-41 Solo/Chrome  
 49-2581 33058-29 Servi-Car/Black  
 49-2600 Servi-Car/Chrome  
 17-0283 45 Kick Pedal

**45" Kicker Arm Bolt Kit**  
 Parkerized Chrome Model  
 2792-3 2784-3 WL  
 2797-3 2798-3 Servi-Car



**45" Transmission Shifter Drum** is rolled and formed as original and allows 1947-up forward shift patterns on 45 transmissions.  
 VT No. 49-1028

CLASSIC