



45 Gas and Oil Tanks



45 Tank Set features oil and gas set. Fits 1936-73 Solo and Servi-car.

VT No.	Item	Year
38-0480	WR (5 gallon)	1947-52 (Gas Both Sides)
38-0488	WR (Narrow)	1936-54
	Right Side Oil, Left Side Gas	
38-0492	WR (3)	1947-52
38-0595	Tank 5 Gallon	1936-46
38-0114	Tank Set	1936-46
38-0594	Tank Set	1947-73
38-1645	Brackets	1941-73

***Note:** All tanks with shut off rod provisions may require fuel rod alignment before installation of shut off assembly.

38-7018 **Early Chrome 45 Gas Oil Cap Set** fits 1936-73 models, oil cap says "OIL"

VT No.	Item
38-7018	Set
49-0108	Oil Only

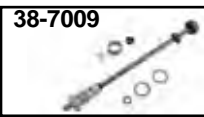

Fuel Shut Off Rod Kits.

VT No.	Fits	Type
38-7009	1941-49	Stock
38-0198	1950-57	Stock
38-0971	1941-49	Viton
38-0431	1941-54	Viton
38-6653	1941-65	Stock
38-1135	1950-65	Stock
38-0418	Rod Only	Viton
35-0291	Viton Tip	



Gas Valve Shut Off Tool replaces 96365-42 to correct alignment of bottom and top holes of 1940-65 gas tanks.

VT No.	Item
16-0615	OE Style
16-0182	Shop



Top of Tank Screw and Washer Kit mount tank to frame on 1918-36 45's. Includes paper gasket to avoid paint chipping.

VT No.	Item
8821-18	Nickel Plated
8822-18	Cadmium Plated



45 Solo and Servi-Car Gas/Oil Tank Mount Bolt Kits includes special washers, studs, and bolts.

Chrome	Parkerized
9894-12	9896-12



45 Tank Filler Strip replaces 3502-37B on 45's and Servi-Car 1937-1973.

VT No.	Item
49-0121	Zinc
49-2526	Chrome



Oil Dip Stick replaces 62631-37 on all 45's 1937-73. VT No. 49-0084



Cables fit 1937-52 45" Solo models.

VT No.	Type	OEM	Length	End
36-0622	R. Wheel	67023-37	50"	5/8" M
<i>Fits 1937-52 45" Solo Models fit late type VT Speedo.</i>				
36-0624	R. Wheel	—	50"	5/8" F
<i>Fits 1937-61 Servi-Car Models.</i>				
36-0600	Rear End	67028-51	54 1/2"	5/8" M
<i>Fits 1962-73 45" Servi-Car Models.</i>				
36-0626	Rear End	67028-62	54 1/2"	5/8" F



Side Valve Speedometer Cable Clamps note cable size of fitment.

Colony	VT No.	#	OEM	Fits	Type
9649-5	37-9234	D	67086-39	1937-48 UL	Mid
9647-1	—	B	67074-37	1937-53 45	Mid
9648-1	37-9219	C	67076-41	1937-53 45, rear	Mid