

Points Conversion Kit. Both brands include everything necessary for direct replacement on 1970-78 Big Twin, 1971-78 Sportsters or for converting late model electronic-type back to points. Accel type available with microchip points, which will require a domed shaped points cover such as VT No. 42-0299 to accommodate taller points. The V-Twin unit includes stock style points and condenser and is available with stock needle bearing weights.

VT No.	Item	Type
32-7773	Accel with Microchip	Stock
32-0136	V-Twin with Points	Stock
32-0150	V-Twin/Points	Needle

Points Plate Screws.		
VT No.	Year	Type
32-0049	1982-up	Steel
32-0760	1982-up	Stainless
32-0051	1970-81	Steel
2743-2	1982-up	Oversize



Tune-able Advance Unit features stainless base, heat treated weights cam bolt and 3 different color coded spring sets which allows full advance at 1400, 2000, and 2600 RPM depending on which springs are selected. Can be used with all ignitions, points, single or dual fire types which utilize an advance unit. Springs also available separately.

VT No.	Type
32-9220	Stock
32-9261	Needle Bearing
13-0121	Stock Springs, Black
13-9246	Heavy
13-9247	Severe



Competition Advance Unit features machined stainless steel shaft and plate, metallic coated weights and special wound springs for exact advance. Replaces 32505-78A for 1970-up, mechanical advance applications. Center screw included.

VT No.	Item	Brand
32-9037	Competition Unit	Rivera
32-9220	Complete with tune-able springs	V-Twin

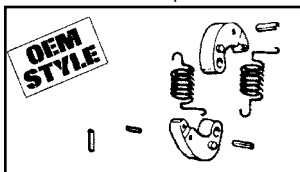

Automatic Advance Rebuild Kit includes two springs, two weights, and roll pins. For all 1970-78 Twins.

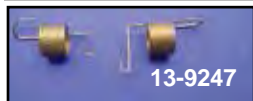

1970-up Advance Weight Springs.

VT No.	Fits
13-9247	Severe Duty Advance Weight Springs for all Hi-compression and heavily modified engines. Also useful for applications experiencing detonation (pinging) or very erratic idle, pair
13-9246	Heavy Advance Weight Springs for slightly modified stock, low compression or mild stroker application, helps cure minor idle problems, pr
13-0121	Original type replacement. Uses premium grade spring steel, 10 pack

Ignition Wire Chrome Clamps.		
VT No.	Type	
37-9014	Points	
37-9015	Electronic	

Ignition Advance

Blue Streak Sifton "Tune-able" Ignition Advance Assembly includes stainless advance base, points plate with "Blue Streak" points and condenser with hardware and 3 pairs of color coated springs which allow full advance at 1400, 2000 and 2600 RPM depending on which spring is selected. **VT No. 32-0713**



Points Plate Assembly available as stock point and condenser replacement fits for 1970-78.

VT No.	OEM	Item
32-0549	32577-70	Point Plate Assembly
32-0042	32618-70A	Mount Plate Only
37-8809	1047	Point Mount Plate Screws with washer assortment
	7115, 6189W	



Stainless Advance Unit features stainless base, heat treated weights and cam center screw for 1970-up mechanical advance ignition. **VT No. 32-0178**



Advance Units feature heat treated weights and steelbase for 32-7510.

VT No.	Type	Type
32-7510	Advance	Steel
32-0168	Advance	Stainless without bolt
32-0055	Center bolt	Steel

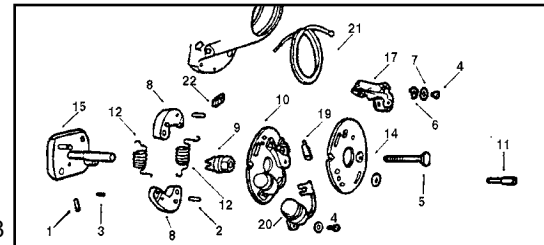

Advance Unit Rebuild Parts.

VT No.	OEM	#	Item
32-7510	32505-78A		Rotor and Weight Assembly
12-1163	615	1	Roll Pin Breaker Plate
12-1164	620	2	Roll Pin Breaker Weight
12-1162	623	3	Roll Pin, Breaker Plate
12-1152	8699		Pop Rivet for Cover
37-8809	1047, 7115, 6189W	4	Point Mount Plate Screws with Washer Assortment
32-0055	3570	5	Timing Screw
32-0138	32522-70	8	Weight Set
32-0053	32542-70A	9	Cam only
32-0549	32577-70	10	Breaker Base Assembly
32-0051	32601-78	11	Plate Mount Stud 1970-81
32-0049	32606-82	11	Plate Mount Stud 1982-up
32-0054	As Above	11	Oversize with 1/24 threads for Stripped out Covers
13-0121	32605-70	12	Springs
32-0042	32618-70A	14	Mount Plate only
32-0118	32661-70	17	Point Set
32-0411	32670-70	19	Terminal Kit
32-0121	32726-30A	20	Condenser and Bracket
32-1316	5 pack	20	Condenser and Bracket
32-1557	70456-73	21	Point Lead Wire
37-8971	10046	22	Point Lead Wire Clamp