

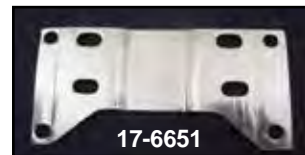

Trans Mount Plate

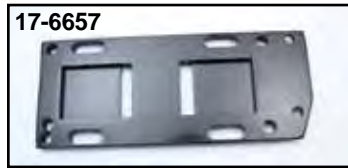

Replica Big Twin Transmission Plate Kit includes adjuster strap and all hardware necessary for installation.

VT No.	Finish	Year
17-0244	Chrome	1936-57
17-0245	Parkerized	1936-57
17-0246	Chrome	1958-64
17-0247	Black	1958-64

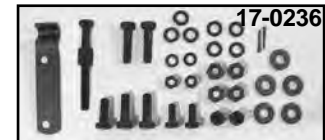
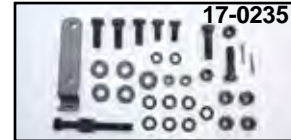

Adjusting Strap Kit for 1936-64 Big Twin includes strap, adjusting screw and mount bolts.

VT No.	Finish
17-0235	Parkerized
17-0236	Chrome



Replica Parkerized Adjuster Kit includes adjuster screw with machined head and correct straps. Fits 1941-64 FL.

VT No. 17-0891

Steel Transmission Mount Plates.

VT No.	OEM	Fits	Finish
17-6660	47698-36	1936-57	Chrome
17-6654	47698-36	1936-57	Black
17-6650	47698-36	1936-84 74 and 80 Big Twin	Chrome
	47698-65	Rigid/Swing arm 4-Speed	
17-6657		As Above	Black
17-6653	47698-58A	As Above	Parkerized
17-6651	Custom	Fits Rigid mount 5-Speed Transmission in 4-Speed, Paughco Frame	Zinc
17-6658	Custom	Fits 4-Speed Transmission in 5-Speed, Paughco Frame	Chrome



Adjustable Transmission Plate. The built in dual adjusters operate from the end of the 1/2" thick steel place by counter bored socket head screws which allow accurate alignment of the mainshaft and are ideal for open belt drives models. The three holes at the front fit various frames. Fits 4 speed Big Twin transmissions from 1979-86 with flat bottom cases and 1936 to early 1978 cases if the sliders are milled off the bottom of the case.

VT No.	Finish
17-7660	Chrome
17-7661	Black



Billet Offset Transmission Plates for 4-Speed, 1/4" offset.

VT No. 17-0790



Rigid Frame Transmission Plate Spacer will raise transmission position on 1936-57 frames.

VT No. 31-0491



(A) Transmission Adjuster Kit includes three pieces as shown allowing the late model transmission case to be secured and adjusted. Strap and adjuster bolt available separately. For use on 1936-64 model Big Twin.

VT No.	OEM	Item	Finish
17-0110	Kit	Adjusting Set, 3 piece	Chrome
17-0108	47720-36	Strap	Chrome
17-0109	47720-36	Strap	Black Phosphorized
17-0107	34735-36	Adjuster	Chrome
9735-1	34735-36	Adjuster	Chrome
9737-1	As Above		Parkerized
9736-1	As Above		Cadmium

(B) Even Pull Kit allows a more positive even transmission adjustment. For use on late style transmission assembly in a rigid frame.

VT No. 17-6655

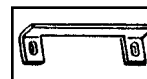

Transmission Bolt Lock Tab replaces 34747-65. Will lock the front 2 bolts securing the transmission plate to frame on 1965-84 Big Twin.

VT No. 17-0943