

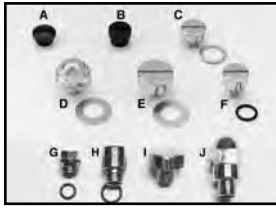

Big Twin Oil Pump



Tappet Oil Screen, Oil Pump Check Valve and Relief Valve Plugs.
Replacement styles as shown.



VT No.	#	OEM	Fits	Finish
8702-2	G	26362-36	1936-80 Check Valve	Chrome
9523-1	B	26362-36	1936-80 Check Valve	Cadmium
9524-1	B	26362-36	1936-80 Check Valve	Parkerized
9525-1	B	26362-36	1936-80 Check Valve	Chrome
9526-1	A	26367-36	Stock, 37-52 By By-Pass	Cadmium
9527-1	A	26367-36	Stock, 37-52 By By-Pass	Parkerized
9528-1	A	26367-36	Stock, 37-52 By By-Pass	Chrome
8704-2	G	24987-52	1952-65 Tappet Screen	Chrome
9603-2	C	24087-52	1952-65 Tappet Screen	Cadmium
9604-2	C	24987-52	1952-65 Tappet Screen	Chrome
9605-2	D	26377-54	Oil Pump Relief 1954-67	Chrome
9606-2	D	26377-54	Oil Pump Relief 1954-67	Cadmium
8705-2	G	655	1966-69 Tappet Screen	Chrome
9874-2	C	655	1966-69 Tappet Screen	Chrome
9875-2	C	655	1966-69 Tappet Screen	Cadmium
37-9222	2	Plugs	1952-65 Set	Chrome
37-9223	2	Plugs	1966-67 Set	Chrome
37-9224	3	Plugs	1966-69 Set	Chrome
8706-6	G	3 Plugs	1970-80 Set	Chrome
8707-6	G	26263-80	1981-99 3 Piece Set	Chrome
37-9225	H	3 Plugs	1970-80 Set	Chrome
37-9226	H	3 Plugs	1981-99 Set	Chrome
2074-6	H	3 Plugs	1981-99 Set	Chrome
2073-2	H	1981-99	1981-99 Each	Chrome
8701-2	G	657	1970-80 Tappet Screen	Chrome
8701-2T	G	657	1970-80 Tappet Screen	Chrome
9876-2	C	657	1970-80 Tappet Screen	Chrome
9877-2	C	657	1970-80 Tappet Screen	Cadmium
8700-2	G	26377-68	1968-80 Relief Valve	Chrome
37-9068	E	26377-68	1968-80 Relief Valve	Zinc
9607-2	E	26377-68	1968-80 Relief Valve	Chrome
9608-2	E	26377-68	1968-80 Relief Valve	Cadmium
9608-2T	E	26377-68	1968-80 Relief Valve	Cadmium
8703-2*	G	26263-80	1980-99 All	Chrome
8703-2T*	G	26263-80	1980-99 All	Chrome
9644-2*	F	26263-80	1980-99 All	Chrome
9645-2*	F	26263-80	1980-99 All	Cadmium
9634-4	F	26263-80	1980-99 2 Piece Set	Chrome
9635-4	F	26263-80	1980-99 2 Piece Set	Cadmium
37-8960*	J	26279-89	1981-99 All Dome Acorn	

*Note: The 1981-up uses the same plug on check valve, tappet screen and relief valve

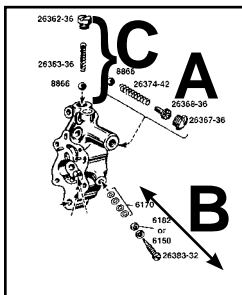

A-Bypass Kit fits 1937-40 EL and FL.

VT No. 12-1477

B-Oil Pump Adjusting Screw Kit fits 1936-54 Big Twin and 45, includes screw, shims, washer and nut.

VT No. Item

12-1465 Kit
12-0584 Screw

C-Check Valve Kit includes cap, spring and ball.

VT No. 12-1481

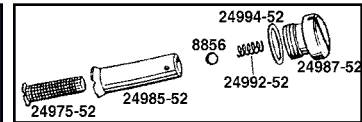

Oil Screen Parts Kit for 1952-62 includes all parts shown 24975-52 screen, 24985-52 housing body, 8856 ball, 24992-52 spring, 24987-52 plug, and 24994-52 washer.

VT No.	Item
12-0159	Kit
12-1522	Screen, each
15-0306	Cork Seal, 24990-52, 10 pack
12-0176	Housing Body

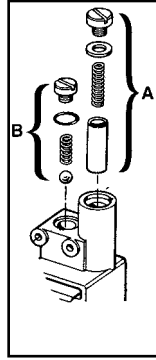

A-Relief Valve/By Pass Kits include spring, plug and valve.

VT No.	Year
12-1477	1937-53
37-8946	1954-67
12-1484	1968-72
12-1485	1973-80
12-1486	1981-2000

B-Check Valve Kits include ball, spring and cap.

12-1490	1936-55 and 1966-80
12-1489	1956-65
12-1487	1981-99

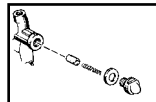

Oil Pump Relief Valve Kit for 1954-67 includes plug, spring and valve. VT No. 37-8946

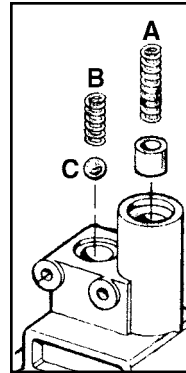

A-Relief Valves and Springs.

VT No.	OEM	Years	Item
13-0107	26374-54	1952-72	Spring
13-0217	26374-42	1941-52	Spring
13-0111	26207-83	1983-00	Spring
12-1417	26400-54	1954-81	Valve

B-Check Valve Springs.

VT No.	OEM	Years
13-0113	26363-36	1936-55 1966-76
13-0114	26363-56	1956-65
13-0112	26262-80	1981-99

C-Ball
12-0158 8866 1954-99

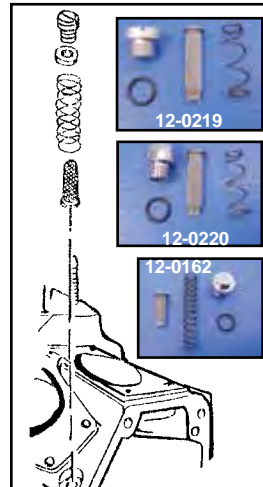

Oil Screen Kit includes proper plug, screen o-ring and spring.

Chrome Cap	Stock Replica	Years
12-0151	12-0219	1970-80
12-0152	12-0220	1981-84
—	12-0159	1952-62
12-0162	12-0217	1963-65
12-0150	12-0218	1966-69

Tappet Oil Screens are exact replacement of OEM, sold each.

12-1522	24975-52	1952-62
12-1529	24975-63	1963-65
12-1516	24981-66	1966-69
12-1515	24981-70	1970-99

Oil Screen Spring for the tappet oil screen, sold in pack of 10.

13-0216	24992-52	1952-62
13-0164	24979-63	1963-65
13-0108	24982-66	1966-69
13-0109	24982-70	1970-82



"Super-Pump" Spring Kit for 1966-99 Big Twin.

VT No.	Brand
13-0575	VT
13-9222	E.R.T. SP-1