



Primary Hardware



Aluminum Inner Primary Mounting Kits contain all stock type hardware for mounting aluminum inner chain housing on all Big Twin.

VT No.	Years/Models
37-8668	1985-88 FXST
9904-17	1986-up FXR-FLT
37-9120	1989-up FXST
9870-16	1986-93 Softail and Dynaglide, Colony
9873-16	1994-up As Above
17-0946	1987-90 Lock Tab Only
37-8803	1971-up Bolt with Wire Hole
17-0928	1985-up Big Twin, Lock Tab



Shift Shaft Primary Plug for use when forward controls are installed on FXR-FXD models to seal the inner primary when eliminating the mid shift. Includes O-Rings and hardware.

VT No. 17-0650

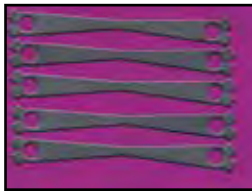

1970-up Big Twin Inner Primary Lock Tab. One piece design eliminates need for safety wire. Sold as a 5 pack.

VT No. 17-0937



17-0870



17-0871



12-0589



12-0591



17-0870

Inner Primary Bearing Kit for Late 1985-up Big Twins includes bearing, seal, two snap rings and one inner race.

1985-93	1994-05	2006-07	2008-up
12-0589	12-0591	17-0871	17-0873
17-0870	1985-05	Bearing/Sleeve	



12-0318

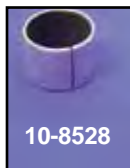

10-8528

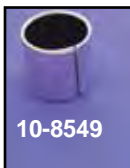

10-8549



10-2488

Outer Primary Cover Bushing/Bearing presses in outer primary cover to secure end of starter shaft.

VT No.	OEM	Years	Type
12-0318	9063	1965-88	Needle Bearing
10-8528	33446-89	1989-93	Bushing
10-8549	33446-94	1994-up	Bushing
10-2488	34632-84B	1984-94	Bushing (FXR)



15-0781

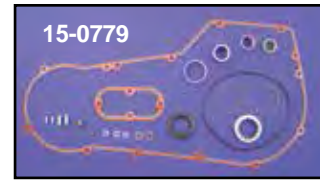

15-0779



15-0782

1994-up Inner Primary Hardware and Gasket Set for Softail models. Set includes all parts shown including bearing and inner sleeve.

VT No.	Year
15-0781	1986-89
15-0782	1990-93

VT No. Year

15-0779 1994-06

15-0784 2007-up



12-9935



12-0357



17-9941

Late 1984-up Big Twin Inner Primary Bearing supports transmission mainshaft at inner primary area. Available in OEM floating style roller bearing **Type (B)** which requires purchase of the inner sleeve, 17-9941. **Type (A)** is the double sealed ball bearing style which does not require the sleeve.

VT No.	Type
12-9935	Sealed Ball Bearing (A)
12-0357	Stock Roller Bearing (B)
12-1279	Bearing Only, 2007-up
17-9941	1984-05 Sleeve
12-9935	As Above Sleeve Not Required
14-0104	1970-84 Seal, 5 pack

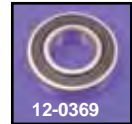

12-0369

Bearings Only, Number of Shields Noted.

12-0369 1984-up 5-Speed FXR-FLT, two shields



Stepped Inner Primary Bearing Race for all 1991-05 Big Twins features an extra step on the inside diameter that acts as a stop on the transmission mainshaft. When the race is pressed on the shaft the step will not allow the race to move inward toward mainshaft seal.

VT No. 17-0465

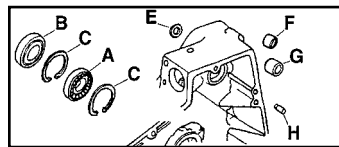

12-9755



12-1198

Late 1984-up Inner Primary Hardware fits Big Twin 5 Speed FXST-FLST.

VT No.	#	OEM	Item
12-9755	A	9135	Bearing
14-0159	B	12052	Seal, 1985-up, 5 pack
12-0969	C	60678-85	Retaining Ring
10-8527	F	33445-89	Bushing Starter Shaft Inner, 1989-93
10-8548	F	33445-94	As Above, 1994-up
14-0920	E	12053A	Seals, 1989-93, 5 pack
14-0961	E	12066	Seal 1994-up
12-1198	H	221	Pin, Dowel, FLT, FXR, 1984-up
10-8528	G	33446-89	Bushing Starter Outer
10-8549	G	33446-93	As Above, 1994-up
12-1253	H	—	Transmission Dowel Pin
12-1172	H	—	1986-up FXST-FLST