



Jets for S&S



Jet Assortment for S&S Super 'E', 'G' and 'B' carburetors. Complete kit includes 7 intermediate jets from .025" to .033" and a main jet kit only which includes 14 main jets from .062" to .084".

VT No. Kit
35-0995 Complete
35-0287 Main Only



Main Jets for S&S. Use when installing new exhaust system or just tuning for better performance and mileage. Sizes available in increments of .002 and ranges in sizes from .040 to .104. Sold each.

VT No.	Size	VT No.	Size	VT No.	Size
35-0300	.040	35-0312	.062	35-0323	.084
35-0301	.042	35-0313	.064	35-0324	.086
35-0302	.044	35-0314	.066	35-0325	.088
35-0304	.046	35-0315	.068	35-0326	.090
35-0305	.048	35-0316	.070	35-0327	.092
35-0306	.050	35-0317	.072	35-0328	.094
35-0307	.052	35-0318	.074	35-0329	.096
35-0308	.054	35-0319	.076	35-0330	.098
35-0309	.056	35-0320	.078	35-0331	.100
35-0310	.058	35-0321	.080	35-0332	.102
35-0311	.060	35-0322	.082	35-0333	.104

Intermediate Jets fits all S&S carburetors.

VT No.	Size/No.	VT No.	Size/No.
35-0350	.025 #1	35-9174	.032
35-9173	.0265	35-0354	.033 #4
35-0351	.028 #2	35-0355	.036 #5
35-0352	.0295 #2 1/2	35-0356	.040 #6
35-0353	.031 #3		

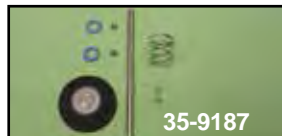
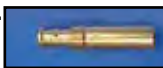

S&S Super 'E' & 'G' Rebuild Kits & Replacement Parts. Rebuild kits contain all the parts necessary for a complete overhaul.

VT No.	Fits
35-0850	Super 'E' Body Kit VT
35-9185	Super 'E' Body Rebuild S&S
35-9186	Super 'G' Body Rebuild
35-0966	Accelerator Rebuild Only, Super 'E' & 'G' V-Twin
35-9187	Accelerator Rebuild Only, Super 'E' & 'G' S&S
35-9240	Super 'E' Master Rebuild
35-9355	Sifton Super 'E' Rebuild
35-9241	Super 'G' Master Rebuild
35-9183	Super 'E' Float for Above
35-9189	Super 'E' Float VT
35-0849	360° Carburetor Fuel Inlet
15-0319	Float Bowl Gasket Only, Super 'E' & 'G' each
35-0234	Needle and Seat Super 'E' & 'G'
35-0970	Needle and Seat Super 'E'
35-0978	Needle Only
35-0924	Needle Seat with elbow
35-0235	1/4" Insulator Block, 1 7/8" Carburetors
35-0258	1/4" Insulator Block, 2 1/8" Carburetors
35-0236	Choke Lever
35-2388	Replacement Float Bowl Super 'E' & 'G'

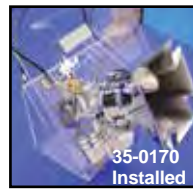
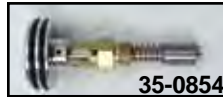

Enricher for S&S Super E & G features 3 positions.
VT No. Type
35-0170 Pike
35-0854 O-Ring



Sifton Enricher for S&S, fits Super 'E' & 'G' and 'B' carburetors, includes chrome knob.
VT No. 35-0466



Enricher Assembly for S&S can be used on S&S Super 'E' & 'G' carburetors when a aftermarket air cleaner or velocity stack is used. Does not require lever assembly. Features full on or full off operation only. **VT No. 35-0152**



Long Float Bowl Screws fit S&S 'E' carburetors, to facilitate easy removal of bowl.
VT No. Finish
35-0025 Brass
35-0029 Chrome



Fuel Line has a preformed bend which is kink resistant. Line has 90° formed bend.

VT No.	Type	Size
35-0561	Clear	20" x 5/16"
35-0562	Black	20" x 5/16"



S&S Super "E" Cruise Control Adapter Kit make any Super "E" carburetor compatible with the stock cruise control. Fits 1998-up.
VT No. 31-2927



Breather Bolt Set fits 1993-up.
VT No. 35-1704



Throttle Cable Brackets for S&S. These brackets allow the use of stock type cable on S&S "E" & "G" carburetors.

VT No.	Type	Years
35-0150	Short	1981-89
35-0151	Long	1990-up



Pingel® Power Flow Valve has a single outlet with reserve. Manufactured as a one piece billet brass unit featuring a 6AN threaded fitting for fuel line hook up using stainless steel hose and fittings, carburetor fitting for Super 'E' & 'G' sold separately.

VT No.	Item
35-0420	Petcock
35-0421	S&S Carburetor Fitting

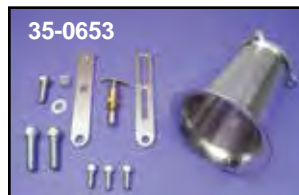

Chrome Velocity Stack Kit includes stack, bracket and enricher knob to fit S&S.

VT No.	Type	Finish	Type	Size
35-0653	S&S	Natural	E & G	4"
34-1165	V-Twin	Chrome	E & G	4"
34-1177	V-Twin	Chrome	B	2"-5"