



Starter Shaft 1989-up



32-9201

Easy Starter Kits for Big Twin models improves starting on high compression big inch engines through an improved starter-to-clutch basket gear ratio. Complete kits include a clutch basket with bearing for Big Twin models with 66-tooth starter ring gear and a 9-tooth starter pinion gear.

| VT No. | Year |
|---------|---------|
| 18-1220 | 1994-97 |
| 18-1221 | 1998-06 |
| 32-9201 | 9T Gear |

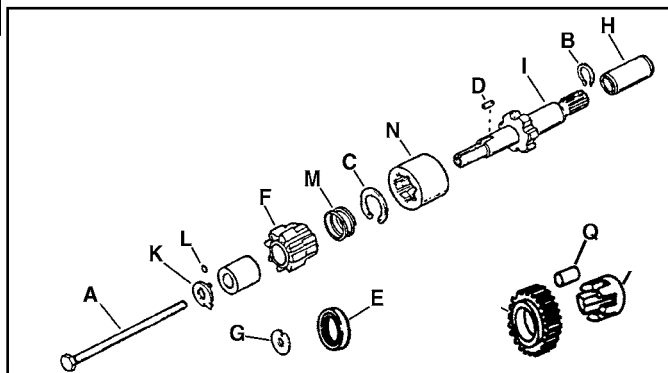

Ring Gears



18-8319

Big Twin Starter Ring Gears for replacement on stock clutch drums only bolt on type. **Note:** Bolt on types include screws.

| VT No. | Year | Teeth |
|---------|----------|-------|
| 18-8307 | 1991-93 | 66T |
| 18-8308 | 1994-97 | 102T |
| 18-8319 | 1998-06 | 102T |
| 37-0018 | Bolt Set | |



32-9238

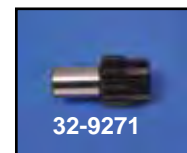

32-9271

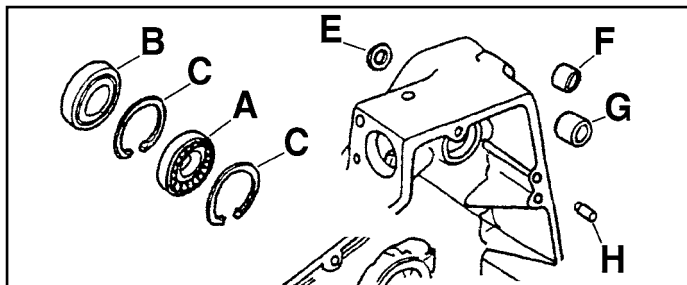

Inner Primary Hardware fits Big Twin 5 Speed 1989-up FXST-FLST.

| VT No. | # | OEM | Item |
|---------|--------|----------|--------------------------------------|
| 12-0357 | A | 9135 | Bearing |
| 14-0159 | B | 12052 | Seal, 1985-up, 5pack |
| 12-0969 | C | 60678-85 | Retaining Ring |
| 10-8527 | F | 33445-89 | Starter Shaft Inner Bushing, 1989-93 |
| 10-8548 | F | 33445-94 | Starter Shaft Inner Bushing, 1994-up |
| 14-0920 | E | 12053A | Seals, 1989-93, 5 pack |
| 14-0961 | E | 12066 | Seal 1994-up |
| 12-1198 | H | 221 | Pin, Dowel |
| 10-8528 | G | 33446-89 | Starter Shaft Outer Bushing |
| 10-8549 | G | 33446-93 | Starter Shaft Outer Bushing, 1994-up |
| 10-1312 | Custom | | Starter Outer Shaft Bushing, raw |
| 12-1253 | H | — | Transmission Dowel Pin |

1989-up Big Twin Starter Coupler and Related Parts

| VT No. | OEM | # | Item |
|---------|----------|---|------------------------------------|
| 37-9243 | 4325 | A | 1989-93 Bolt |
| 37-9244 | 4358 | A | 1994-up Bolt |
| 12-0981 | 11182 | B | 1989-up Retaining Ring |
| 12-0978 | 11183 | C | 1989-93 Retaining Ring |
| 12-0985 | 11248 | C | 1994-up Retaining Ring |
| 12-0216 | 11220 | D | 1989 Key |
| 14-0920 | 12053A | E | 1989-up Seal |
| 32-9270 | 31342-93 | F | 1993 Pinion Gear |
| 32-9271 | 31342-94 | F | 1994-up Pinion Gear |
| 32-9227 | 31430-90 | G | 1993 Thrust Washer |
| 32-9273 | 31430-94 | G | 1994-up Thrust Washer |
| 32-9238 | As Above | | 1989-93 Shaft and Gear Kit, Sifton |
| 32-9228 | 31548-90 | H | 1990-up Coupling |
| 32-9275 | 33120-89 | I | 1989 Shaft |
| 32-9277 | 33127-93 | I | 1993 Shaft |
| 32-9278 | 33127-94 | I | 1994-up Shaft |
| 17-0930 | 33125-89 | K | 1989 Lock Plate |
| 32-9229 | 33126-90 | K | 1990-92 Lock Plate |
| 32-9280 | 33126-93 | K | 1993 Lock Plate |
| 32-9281 | 33126-94 | K | 1994-up Lock Plate |
| 14-0569 | 33345-89 | L | 1989 O-Ring |
| 14-0960 | 33340-90 | L | 1990-91 O-Ring |
| 13-9203 | 33447-89 | M | 1989 Spring Pinion Gear |
| 13-9221 | 33449-90 | M | 1990-93 Spring Pinion Gear |
| 13-9255 | 33449-94 | M | 1994-up Spring Pinion Gear |
| 17-9162 | 60647-90 | N | 1990-93 Coupling |
| 17-9164 | 60647-94 | N | 1994-up Coupling |



12-0589



12-0591



15-0779

Inner Primary Bearing Kit for Late 1985-up Big Twins includes bearing, seal, two snap rings and one inner race.

| | |
|--------------------|---------|
| 1985-93 | 1994-05 |
| 12-0589 | 12-0591 |
| Kits with gaskets. | |
| 15-0779 | 1994-06 |
| 15-0781 | 1986-89 |
| 15-0782 | 1990-93 |



15-0781



15-0782