



Mounts for Dynaglide



31-0574



31-0607



31-0679



31-0294



31-1050

Front Mount fits 1990-up FXD.

VT No.	OEM	Item	Fits	Type	Type
31-0574	47583-90B	Mount	Front	Black	1991-2011
31-0607	47564-90B	Mount	Rear	Chrome	1991-98
31-0679	47564-99	Mount	Rear	Black	1999-up
31-0294	16258-95B	Stabilizer	Steel		1995-up
31-1050		Mount	Top	Chrome	1995-up



Chrome Teardrop Coil Cover fits top motor mounts with two holes such as 31-0664. Matches teardrop air cleaners.
VT No. 42-0926



Chrome Finned Coil Cover fits coil mounted on top motor mount.
VT No. 42-0962

Top Mount for FXR



31-0121



31-0155

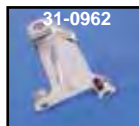

31-0962



31-0682



31-1975



31-0240



31-4065



31-4081



31-0900

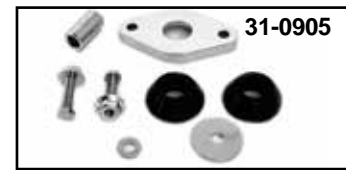

31-0905



31-0258

9859-20 Engine Mount Components

VT No.	OEM	Item	Finish	Fits
31-0121	16207-79B	Front Mount	Black	1979-08 FLT 1984-94 FXR
31-0155	16207-79B	As Above	Chrome	
31-0258	96210-80	Washers for Above	Zinc	
31-0240	16219-79B	Stabilizer Link	Chrome	1979-08 FLT, 1984-94 FXR
31-4065	47159-79A	Front Bracket	Chrome	As Above
31-4081	47159-08	Lower Front Brkt	Black	2009-up FLT
31-0962	16321-08	Upper Front Mt	Chrome	2009-up FLT
31-0054	16219-09	Lower Mount	Stabilizer	2009-up FLT
31-0055	16213-10	Upper Mount	Stabilizer Link, chrome	2009-up FLT

Urethane Engine Mount replaces the stock mount in all Big Twin with rubber mounted engines. It uses urethane formulated compounds with enhanced compression and rebound dampening properties for a 20% reduction in transmitted vibration. Fits 1982-94 FXR.

VT No.	Finish	Brand
31-1975	Black	Velva-Ride
31-0900	Black	Sifton
31-0682	Chrome	Sifton
31-0905	Chrome	Sifton



31-1983

Chrome Engine Stabilizers feature a steel body with a plunger with a urethane dampening which together acts as a mini-shock absorber. Fits 1979-up FL.



VT No.	Year
31-1983	1970-08
31-1274	2009-up



Chrome Front Engine Mount Assembly includes bracket, link and iso mount with hardware. Fits 1982-06 FLT.
VT No. 31-0625



9859-20



37-0952

Lower Engine Mount Kit for 1989-99 FLT-FLHT-FXR-FXRS with rubber mounted engines.
VT No. Finish
9859-20 Colony
37-0952 V-Twin