

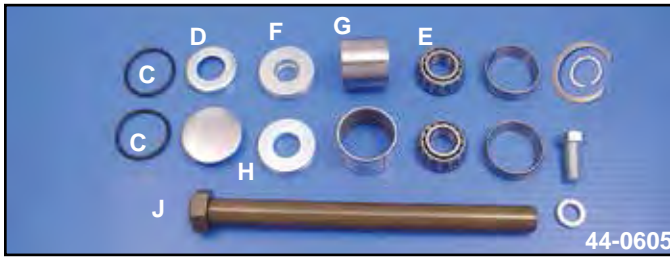

# For FXD-FXDWG Swingarm

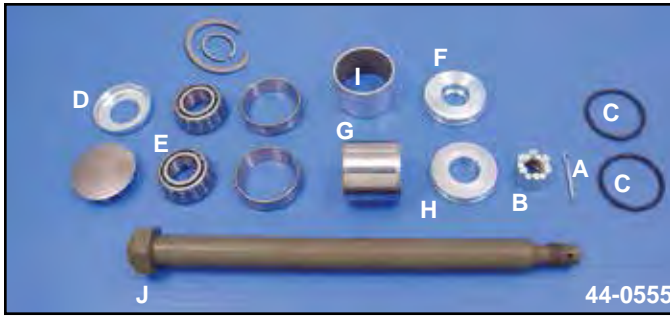

FXD Swingarm Rebuild Parts. Fit all 1991-up Dynaglide.

VT No.	#	OEM	Item
44-0555	A-J		1991-99 Complete Kit
44-0605	A-J		2000-05 Complete Kit
44-0790			2006-up Complete Kit
37-8661	A	534	1991-99 Cotter Pin
37-0564	B	7734W	1991-99 Nut
14-0515	C	11139	1991-up O-ring
44-0590	D	41585-90	1991-up Dust Shield
12-0360	E	47082-81	1991-up Bearing Assembly
44-0591	F	47496-90	1991-up Spacer Left Hand
44-0592	G	47499-90	1991-up Spacer Right Hand
44-0593	H	47565-90	1991-99 Washer
44-0594	I	47624-90A	1991-up Bushing
44-0595	J	47817-90	1991-99 Pivot Bolt
44-0606	J	47817-00	2000-up Pivot Bolt
44-0758	J	47641-06	2006-up Pivot Bolt



**2006-up Chrome Peg Mount Set** fits FXD-FXDWG models. Order male pegs separately.  
**VT No. Item**  
**27-0858** Mounts Stock Height  
**27-0861** Mounts, Raised Height  
**27-1232** Peg Set

## Hard Tail for FXD



**Bolt On Hard Tail Units** to 1990-98 FXD-FXDWG models. Use stock rear wheel or fit up to 200mm width. Order battery box separately. Bottom attaches to swingarm pivot point to aid in alignment.

**VT No. 51-0786**

**Note:** Attachment points, we recommend installation be completed by a qualified technician.

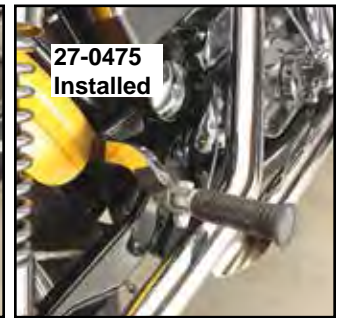

**1994-05 Rear Footpeg Mount Kit** includes right and left bracket. Order pegs separately.

**VT No. Item**

**27-0475** Mount Kit Only

**27-0439** Mount Kit with pegs



**1990-up FXD Driver Footpeg Mounts Set**  
**VT No. 27-0804**