

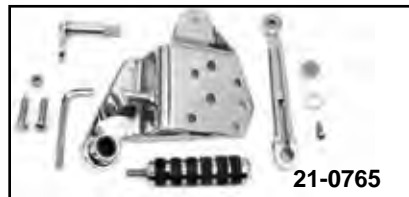

Foot Clutch Control Kit

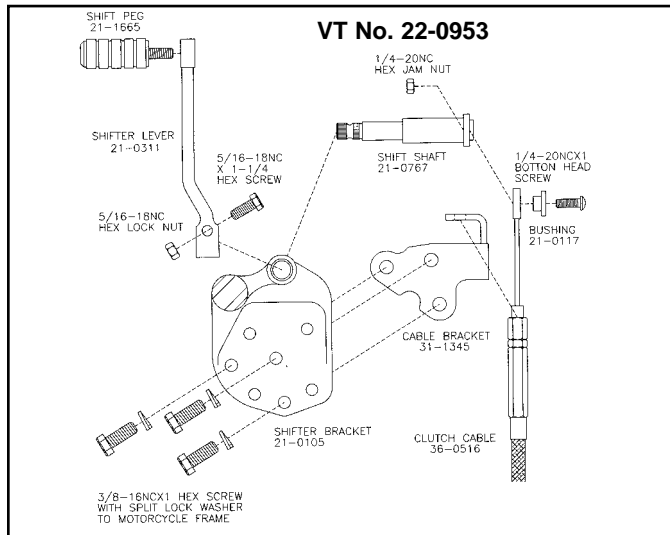

VT No. 21-0765
VT No. 31-1345
VT No. 21-1667
VT No. 21-0767

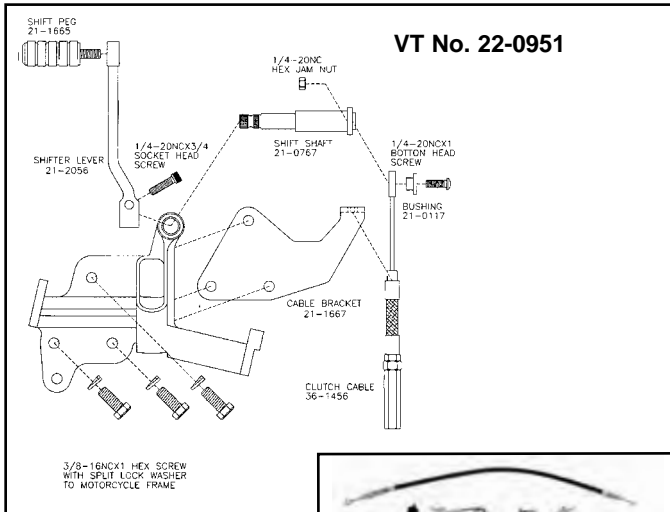

Jockey Kits include shifter peg.

VT No.	Year	Model	Type
22-0950	1986-99	FLST	Footboards
22-0951	2000-06	FLST	Footboards
22-0952	1986-99	FXST	Footboards
22-0953	1990-99	FXST	Pegs
21-0765	1980-99	FX	Pegs
31-1345	1990-99	ST	Bracket
21-1667	2000-06	ST	Bracket
21-0767	1990-99	ST	Shaft

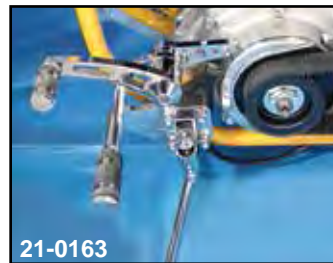

Jockey Pedal Conversion Kit allows conversion of shift side of our Big Twin extended 2" and 3" forward controls to operate as foot clutch. Kit includes splined inner billet arm, black bracket and black cable with ends. Order shift arm or kit separately for appropriate year.

VT No.	Year	Type	Model
21-0151	1987-up	5 Speed	Softail
21-0163	1979-84	4 Speed	Big Twin
36-0516	All	Cable	



Chrome Billet Spacers fit left side shift (3 hole) and right side brake (2 hole) for 1984-99 Softail.

Shift	Brake	Thick
21-0175	21-0164	0.50"
21-0165	21-0166	0.75"
21-0169	21-0170	1.25"
21-0171	21-0172	1.5"