



# Trans Mount Plate



### Steel Transmission Mount Plates.

VT No.	OEM	Fits	Finish
17-6660	47698-36	1936-57 Chrome	
17-6654	47698-36	1936-57 Blac	k
17-6650	47698-36	1936-84 74 & 80 BT	Chrome
	47698-65	Rigid/S Arm 4-Speed	
17-6657		As Above	Black
17-6659	47698-58A	1958-84 4-Speed	Chrome
17-6653	47698-58A	As Above	Black
17-6651	Custom	Fits Rigid mount 5-Speed Transmission in 4-Speed, Paughco Frame	Zinc
17-6658	Custom	Fits 4-Speed Trans in 5-Speed, Paughco Frame	Chrome



**Adjustable Transmission Plate** for 1936-84 Big Twin 4-Speed features built in adjuster screws for positive and even adjustment.

VT No.	Finish
17-7660	Chrome
17-7661	Black



**Billet Offset Transmission Plates** for 4-Speed.

VT No.	Offset
17-0790	1/4"
17-0860	3/4"



**Rigid Frame Transmission Plate Spacer** will raise trans position on 1936-57 frames.

VT No. 31-0491

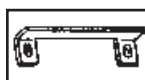

**Transmission Bolt Lock Tab** replaces 34747-65 will lock the front 2 bolts securing the transmission plate to frame on 1965-84 Big Twin.

VT No. 17-0943

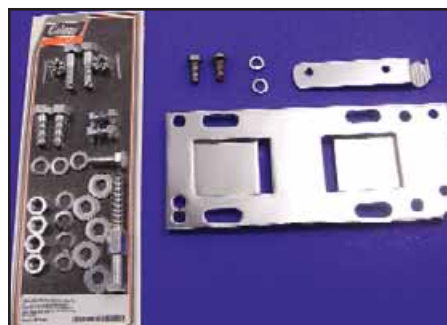

**Replica Big Twin Trans Plate Kit** includes adjuster strap and all hardware necessary for installation.

VT No.	Finish	Year
17-0244	Chrome	1936-57
17-0245	Parkerized	1936-57
17-0246	Chrome	1958-64
17-0247	Black	1958-64

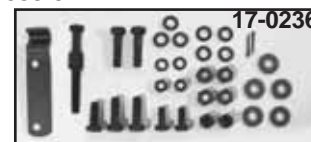

**1936-64 Big Twin Adjusting Strap Kit** includes strap, adjusting screw and mount bolts.

VT No.	Finish
17-0235	Parkerized
17-0236	Chrome



**(A) Transmission Adjuster Kit** includes 3 pieces as shown allowing the late model transmission case to be secured & adjusted. Strap & adjuster bolt available separately, for use on 1936-64 model Big Twin.

VT No.	OEM	Item	Finish
17-0110	Kit	Adjusting Set, 3 piece	Chrome
17-0108	47720-36	Strap	Chrome
17-0109	47720-36	Strap	Black Phosphorized
17-0107	34735-36	Adjuster	Chrome
9735-1	34735-36	Adjuster	Chrome
9737-1	As Above		Parkerized
9736-1	As Above		Cadmium

**(B) Even Pull Kit** allows a more positive even trans adjustment. For use on late style trans assembly in a rigid frame.

VT No. 17-6655