



1984-99 Chrome Billet Pushrod Cover Kit includes all pieces and seals for complete installation on Ev BT models.
VT No. 11-0947

Pushrod Cover Components



Lower Push Rod Tube Sets.

Chrome Plated

VT No.	OEM	Brand	Year	Model
11-0913	17938-83	V-Twin	1984-99	Evo
9202-12	17938-83	Colony	1984-99	Evo
9968-12	17938-99	Colony	1999-up	TC-88
11-9970	17938-99	V-Twin	1999-up	TC-88

Gold Plated

11-0914	17938-83	V-Twin	1984-up	Evo
---------	----------	--------	---------	-----



11-0928



Replacement Chrome Upper Pushrod Cover Kits (Outer).

Each kit contains 4 chrome clips, 4 springs, 4 cork gaskets, and 4 steel washers.

VT No.	Fits	Brand
7508-20	Ev	Colony
11-0928	Ev	V-Twin
9970-20	TC-88, 1999-up	Colony

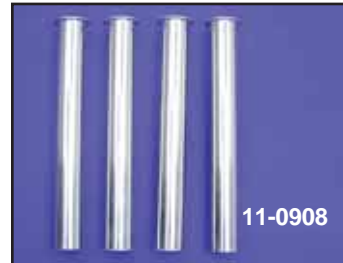

11-0908

Inner Quad Pushrod Covers in zinc plated steel.

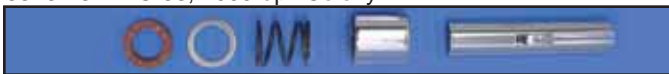

Pushrod Cover Individual Parts, in chrome steel.

VT No.	OEM	Model	U/M
11-0915	17950-66	1966-99 BT Clip Stock	4
11-0942	17634-99	1999-up TC-88 Clip	4
11-0917	17945-36	1936-up Cup	4
13-0101	17947-36	Spring	10
12-0711	6762B	Washer, Inner	10
12-1157	6737	Washer, Lower, Evo	20
15-0117	17955-48	Large Cork	100
15-0116	17955-36	Small Cork	100



Chrome Machined Pushrod Clips fit Evo or Shovel Motors, set of 4.

VT No. 11-0927



Pushrod Cover Rubber Seal Kit includes 12 machined rubber seals for Big Twin Evo. 1984-99.

VT No.	Type
9529-12	Black
14-0981	Blue

VT No.	Year	Brand
11-0908	1979-99	V-Twin
9213-4	1979-99	Colony
9969-4	1999-up	Colony, TC-88
11-9969	1999-up	V-Twin, TC-88

Pushrod Cover Cork-Seal Kits include enough pieces to seal 4 complete pushrod covers on years listed. Rubber seals.

James VT No.	Model/Year
14-0671	14-0951 1984-99 Big Twin 1340 Evo
14-0686	14-0681 2000-up TC-88

Blue Silicone Seals are lathe cut, then ground with perfect O.D. finish, withstand heat, oil and gas.

VT No.	OEM	Item	U/M
14-0028	17955-36	Small Push Rod	50 pk.
14-0029	17955-48	Large Push Rod	50 pk.



Pushrod Tube Quad Seals or O-Rings. Quad Seals feature 4 side seal design, 10 pack.

VT No.	OEM	Use	Year
14-0550	11145	Lower O-Ring	1984-up
14-0532	11157	Upper O-Ring	1984-98
14-0803	11293	Upper O-Ring	1999-up