

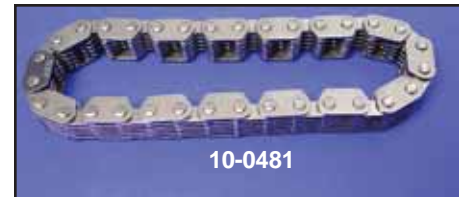

1999-up Cam Shaft Components for TC-88

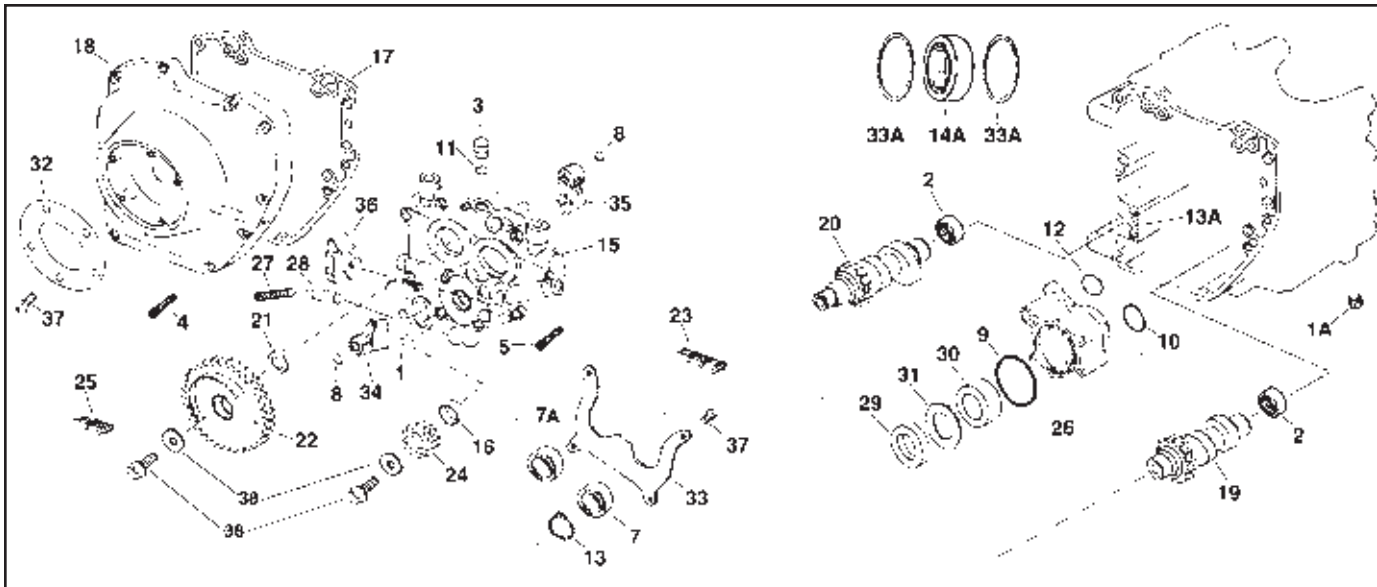

Cam Shaft Components for TC-88 models, 1999-up unless noted.

VT No.	OEM #	Item
12-1178	601	1 Roll Pin
37-1000	765	1A Plug
12-0750	9198	2 Left Side Cam Shaft Bearing 1999-05
12-0765	9215	2 As Above 2006-up
37-1001	3290	3 Cam Support Plate Plug 1999-05
9946-20	4740A	4 Allen Screw Set
37-1002	4741A	5 Screw
12-0751	8990A	7A Ball Bearing 1999-05
12-0762	8983	8 Bearing 1999-05
12-0905	11031	8 Retaining Ring 1999-05
12-0766	942	8 Retaining Screw Chain Tensioner 2006-up
14-0814	11286	9 O-Ring 1999-05
14-0803	11293	10 O-Ring
14-0819	11298	11 O-Ring, Viton 1999-05
14-0820	11301	12 O-Ring 1999-05
12-0753	11494	13 Retaining Ring 1999-05
12-0767	11461	13 As Above 2006-up
12-0761	16589-99	13A Dowel Ring
15-1214	17045-99	14 Cam Service Gasket Kit
12-0754	24623-99C	14A Right Side Main Bearing 1999
12-0763	24604-00C	14A As Above 2000-06
12-0768	24605-07	14A As Above 2007-up
10-0900	25267-99B	15 Cam Support Plate Assy w/bearings, retaining plate, tensioner & bypass valve 1999-05
10-0907	25355-06	15 Cam Support Plate w/Bypass Valve 06-up
10-0901	25344-99	16 Crankshaft Bushing
15-1198	25244-99A	17 Cam Cover Gasket
10-0813	25247-99	18 Chrome Cam Cover
10-8178	25937-99A	18, 20 Cam Shaft Set 1999-05
10-0902	25562-99	21 Cam Drive Spacer, .350 1999-05
10-0903	25595-99	21 Cam Drive Spacer, .355 1999-05
10-0904	25674-99	21 Cam Drive Spacer, .360 1999-05
10-0905	25675-99	21 Cam Drive Spacer, .365 1999-05
10-0906	25676-99	21 Cam Drive Spacer, .370 1999-05
10-0908	25729-06	21 As Above .100 2006-up
10-0909	25731-06	21 As Above .110 2006-up
10-0910	25731-06	21 As Above .120 2006-up
10-0911	25736-06	21 As Above .130 2006-up

10-0912	25737-06	21 As Above .140 2006-up
10-0913	25738-06	21 As Above .150 2006-up
10-0480	25593-99	22 Cam Drive Sprocket, 34T 1999-05
10-0914	25728-06	22 As Above 2006-up
10-0481	25607-99	23 Secondary Cam Drive Chain 1999-05
10-0915	25683-06	23 As Above 2006-up
10-0482	25609-99	24 Crankshaft Sprocket, 17T 1999-05
10-0916	25673-06	24 As Above 2006-up
10-0483	25610-99	25 Primary Cam Drive Chain 1999-05
10-0917	25675-06	25 As Above 2006-up
12-0755	26035-99	26 Oil Pump Assembly Cpt 1999-05
12-0769	26037-06	26 As Above 2006-up
13-0180	26210-99	27 Relief Valve Spring
12-1418	26400-82B	28 Oil Pump Relief Valve
12-0756	26464-99	29 Pressure Geo-Rotor Assy 1999-05
12-0758	26465-99	30 Scavenger Geo-Rotor Assy 1999-05
12-0759	26466-99	31 Geo-Rotor Separator Plate 1999-05
42-0085	32543-99	32 Sensor Cover, Alloy
42-0119	32679-99	32 Sensor Cover, Chrome
10-0484	35052-99	33 Bearing Retaining Plate 1999-05
12-0760	35115-99	33A Retaining Ring 1999-01
12-0764	35114-02	33A Retaining Ring 2002-up
10-0485	39954-99	34 Primary Cam Drive Chain Tensioner 1999-05
10-0918	39968-06	34 As Above 2006-up
10-0486	39964-99	35 Secondary Cam Drive Chain Tensioner 1999-05
10-0919	39969-06	35 As Above 2006-up
10-0487	39965-99	36 Chain Guide 1999-05
9954-5	68042-99	37 Sensor Cover Screw Set
10-0814	25533-99A	38 Sprocket Retention Bolt Washer 1999-05
10-0920	25566-06	38 As Above 2006-up



42-0953 Chrome Crank Sensor Cover Includes mount screw. 1999-up FXD-FLT.
VT No. 42-0953

